



## SC-MP-AR1

The **Quick Reference Card** provides a quick overview of your spa's main functions and the operations accessible with your digital control pad. Note: Functionality depends on system configuration (system can also be equipped with a K-19).

### Starting Pump 1:



Press **Jet 1** to turn pump 1 on at low speed. Press a second time to turn pump 1 to high speed. A third time turns pump 1 off. A built-in timer turns pump 1 off after 30 minutes, unless it has been manually deactivated first.



The "Pump 1" indicator lights up when pump is on. It flashes when pump 1 is on at low speed.

### Starting Pump 2:



Press **Jet 2** to turn Pump 2 on. Press a second time to turn Pump 2 off. A built-in timer turns pump 2 off after 30 minutes, unless it has been manually deactivated first.



The "Pump 2" indicator lights up when pump is on.

### Starting the blower:



Press **Blower** to turn blower on. Press a second time to turn blower off. A built-in timer turns blower off after 30 minutes, unless it has been manually deactivated first.



The "blower" indicator lights up when blower is on.

### Turning the light on:



Press **Light** to turn light on. Pressing a second time turns light off. A built-in timer automatically turns light off after 2 hours, unless it has been manually deactivated first.



The "Light" indicator is displayed when light is on.

### Setting water temperature:



Use **Up** or **Down** arrow key to regulate water temperature. The temperature setting will be displayed for 5 seconds to confirm your new selection.



The "Set Point" indicator displays the desired temperature, NOT the current water temperature!

Water temperature can be adjusted by 1° increments from 59 to 104°F (15 to 40°C).

### Automatic water heater start:

When water temperature is 1°F (0.5°C) lower than the Set Point, the heater will automatically turn on until water temperature reaches Set Point plus 1°F (0.5°C).



The "Heater" indicator lights up when the heater is on. It flashes when there is a request for more heat but the heater has not yet started.

*N.B.: If your system is configured in Low Current Mode, the heater will not start if both pumps are running at high speed.*

### Digital control pad lockout:

This function allows you to prevent unauthorized parameter setting of the unit. This feature is especially helpful when young children have access to the keypad.

#### Locking your digital control pad:

- 1 - Press and hold **Pump 1** key for 10 seconds.
- 2 - The display will show **Loc**
- 3 - Press and hold **Pump 1** key again for 10 seconds to unlock keypad. The display will show **Uic** to confirm.

When control pad is locked, all keypad functions are locked, except the light and pump 1. All automatic functions of the system run as usual.

# PROGRAMMING THE PURGE/FILTER CYCLES

The system either performs 3 purge cycles per 12 hours (every 4 hours) or 2 filter cycles per day, at 12-hour intervals (depending on system configuration). During a purge cycle, pump and blower run for one minute. During a filter cycle, low speed pump runs for the number of hours selected.

To set the purge/filter cycles:

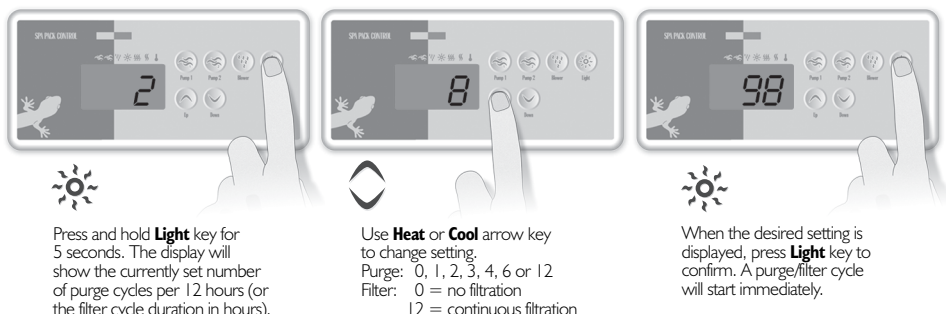

Press and hold **Light** key for 5 seconds. The display will show the currently set number of purge cycles per 12 hours (or the filter cycle duration in hours).

Use **Heat** or **Cool** arrow key to change setting.  
 Purge: 0, 1, 2, 3, 4, 6 or 12  
 Filter: 0 = no filtration  
 12 = continuous filtration

When the desired setting is displayed, press **Light** key to confirm. A purge/filter cycle will start immediately.

Note: Settings are kept in the system's memory (including Set Point and purge/filter cycles settings), even after a power failure.

For systems not equipped with a circulation pump: When water temperature is 2°F (1 °C) higher than the Set Point, the filter cycle will be suspended until water temperature reaches 1°F below the Set Point.

40-minute filter cycle time-out: If you turn a pump, blower or light on during a filter cycle, the filter cycle will be interrupted and will only resume 40 minutes after you (or the system) have turned the last active output off.

Clean up cycle: a 30 minutes clean up cycle is initiated 40 minutes after a pump or the blower (that has been manually activated) is turned off.

## TROUBLESHOOTING



The pump has started up for one minute on several occasions and "Filter Cycle" indicator is flashing.

Not a bug but a feature!

Our **Smart Winter Mode** protects your spa from the cold by turning pumps on for one minute several times a day to prevent water from freezing in pipes.



The "Heater" indicator is flashing when the pump is running at high speed.

Not a bug but a feature!

The heater is automatically turned off when the pump is running at high speed to limit the electrical current draw.



"Pr" error message is displayed.

A problem has been detected with the temperature probe.

Call your dealer or service supplier.



"OH" error message is displayed.

The system has shut down because the water temperature in the spa has reached 112°F (44°C). Only the **Smart Winter Mode** remains active. Do not enter the water! Allow water to cool down to 109°F (43°C), then press any key to reset the system.

Call your dealer or service supplier if problem persists.



"HL" error message is displayed.

The system has shut heater down because water temperature at the heater has reached 119°F (48°C). Do not enter the water! Allow water to cool down to 109°F (43°C), then press any key to reset the system.

Call your dealer or service supplier if problem persists.



"FLO" error message is displayed.

The system detects no water pressure while the pump is running.

Check and open water valves. Check water level. Clean filter. Call your dealer or service supplier if problem persists.



"FLC" error message is displayed.

A problem has been detected with the pressure switch. Call your dealer or service supplier if problem persists.